

Manual

Submersible Pump

**For CLEAN
Water**

Applies for:

Codes	Models
12601	BOS-1/2LP
12600	BOS-3/4LP
12602	BOS-1LP

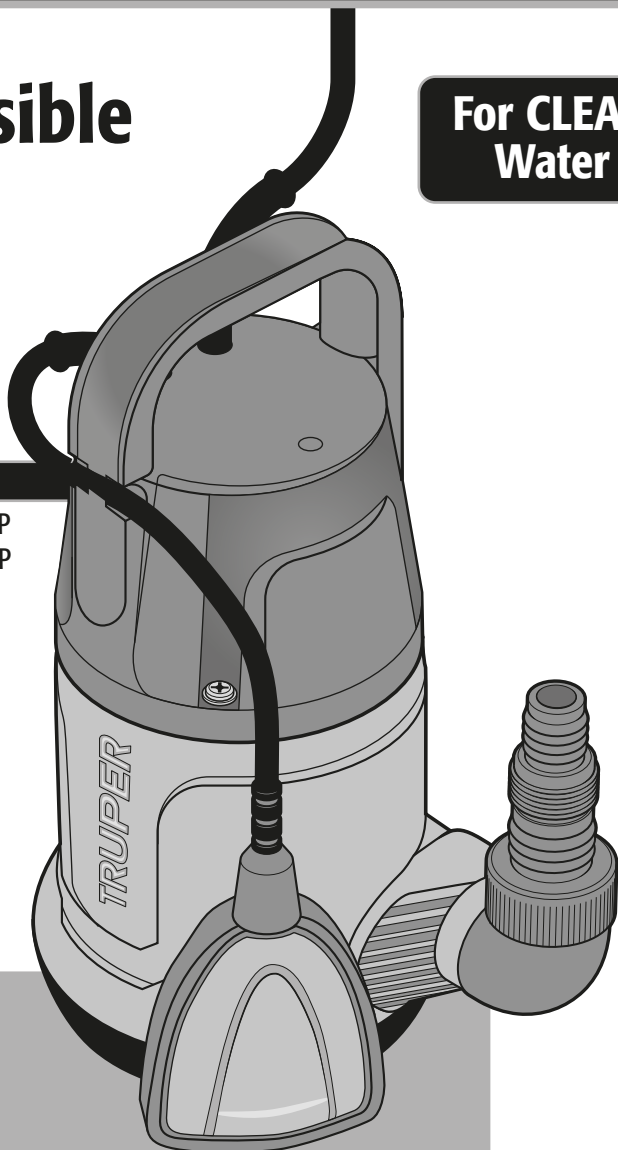

CAUTION



Read the user's manual thoroughly
before operating this tool.



Technical data	3
Power requirements	3
 General power tool safety warnings	4
 Safety warnings for submersible pumps	5
Parts	6
Installation	7
Start up	8
Maintenance	8
Troubleshooting	9
Notes	10
Authorized service centers	11
Warranty	12

CAUTION

To gain the best performance of the tool, prolong the duty life, make the Warranty valid if necessary, and to avoid hazards of fatal injuries please read and understand this Manual before using the tool.

Keep this manual for future references.

The illustrations in this manual are for reference only. They might be different from the real tool.

Use and maintenance recommendations



RESPECT THE DUTY CYCLES.

50 min of work and 20 min of rest. Daily maximum 6 hours.



NEVER use the cord to hold, carry, lift, or disconnect the tool.



Perform periodic **MAINTENANCE** to your machine (page 8).

Technical data

TRUPER

	BOS-1/2LP	BOS-3/4LP	BOS-1LP
Code	12601	12600	12602
Description	Submersible pump for clean water		
Voltage and frequency	127 V~ 60 Hz		
Power	1/2 Hp	3/4 Hp	1 Hp
Current	3.2 A	4 A	6 A
Speed	3 450 RPM		
Flow rate	37 gal/min	45 gal/min	63.4 gal/min
Maximum depth	16.4'	22.9'	26.2'
Maximum height / Maximum value of total gauged height	26.2'	27.8'	32.8'
Power cable	32.8'		36'
Allows particles up to	3/16"		
IP Grade	IPX8		
Conductors	18 AWG x 3 C with 221 °F insulating temperature.		
Insulation	Class I		

Power cord grips used in this product: Type "Y".
Build quality: Basic insulation
Thermal insulation on motor winding: Class B

⚠ WARNING Avoid the risk of electric shock or severe injury. When the power cable gets damaged it should only be replaced by the manufacturer or at a TRUPER Authorized Service Center. The build quality of the electric insulation is altered if spills or liquid gets into the tool while in use. Do not expose to rain, liquids and/or dampness.

⚠ WARNING Before gaining access to the terminals all power sources should be disconnected.



Power requirements

⚠ WARNING In the event of faults or breakdown ground connection supplies a minimum resistance trajectory for the power supply, thus reducing the risk of electric shock. This tool is equipped with a power cable, adapter and ground connection sockets. Ground shall be connected into an outlet installed and grounded following all the local codes.

⚠ WARNING Do not modify the socket supplied. If the socket is not fit for the outlet, have a certified electrician to install the appropriate outlet.

⚠ CAUTION When using an extension cable, verify the gauge is enough for the power that your product needs. A lower gauge cable will cause voltage drop in the line, resulting in power loss and overheating. The following table shows the right size to use depending on cable's length and the ampere capability shown in the tool's nameplate. When in doubt use the next higher gauge.

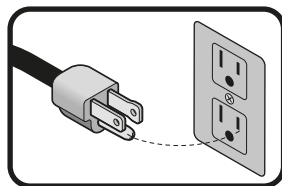

Ampere capacity	Number of conductors	Extension gauge	
		From 6 ft to 49 ft	Higher than 49 ft
From 0 A and up to 10 A	3 (one grounded)	18 AWG	16 AWG
From 10 A and up to 13 A		16 AWG	14 AWG
From 13 A and up to 15 A		14 AWG	12 AWG
From 15 A and up to 20 A		8 AWG	6 AWG

* It is safe to use only if the extensions have a built-in artifact for over current protection. AWG = American Wire Gauge. Reference: NMX-J-195-ANCE

⚠ WARNING When operating power tools outdoors, use a **5 VOLTECK** grounded extension cable labeled "For Outdoors Use". These extensions are especially designed for operating outdoors and reduce the risk of electric shock.



⚠ WARNING All the cabling, power connections and the ground connection of the system shall be in compliance with the Mexican Official Standard **NORMA OFICIAL MEXICANA NOM-001-SEDE, INSTALACIONES ELÉCTRICAS (UTILIZACIÓN)** or with the local codes and municipal by-laws.

ENGLISH

3



General power tools safety warnings



⚠ WARNING! Read carefully all safety warnings and instructions listed below. Failure to comply with any of these warnings may result in electric shock, fire and / or severe damage. **Save all warnings and instructions for future references.**

Work area

Keep your work area clean, and well lit.

Cluttered and dark areas may cause accidents.



Never use the tool in explosive atmospheres, such as in the presence of flammable liquids, gases or dust.

Sparks generated by power tools may ignite the flammable material.



Keep children and bystanders at a safe distance while operating the tool.

Distractions may cause losing control.



Electrical safety

The tool plug must match the power outlet. Never modify the plug in any way. Do not use any adapter plugs with grounded power tools.

Modified plugs and different power outlets increase the risk of electric shock.



Avoid body contact with grounded surfaces, such as pipes, radiators, electric ranges and refrigerators.

The risk of electric shock increases if your body is grounded.

Do not expose the tool to rain or wet conditions.

Water entering into the tool increases the risk of electric shock.

Do not force the cord. Never use the cord to carry, lift or unplug the tool. Keep the cord away from heat, oil, sharp edges or moving parts.

Damaged or entangled cords increase the risk of electric shock.

When operating a tool outdoors, use an extension cord suitable for outdoor use.

Using an adequate outdoor extension cord reduces the risk of electric shock.

If operating the tool in a damp location cannot be avoided, use a ground fault circuit interrupter (GFCI) protected supply.

Using a GFCI reduces the risk of electric shock.

Personal safety

Stay alert, watch what you are doing and use common sense when operating a tool. Do not use a power tool while you are tired or under the influence of drugs, alcohol or medication.

A moment of distraction while operating the tool may result in personal injury.

Use personal protective equipment. Always wear eye protection.

Protective equipment such as safety glasses, anti-dust mask, non-skid shoes, hard hats and hearing protection used in the right conditions significantly reduce personal injury.



Prevent unintentional starting up. Ensure the switch is in the "OFF" position before connecting into the power source and / or battery as well as when carrying the tool.

Transporting power tools with the finger on the switch or connecting power tools with the switch in the "ON" position may cause accidents.

Remove any wrench or vice before turning the power tool on.

Wrenches or vices left attached to rotating parts of the tool may result in personal injury.

Do not overreach. Keep proper footing and balance at all times.

This enables a better control on the tool during unexpected situations.

Dress properly. Do not wear loose clothing or jewelry. Keep hair, clothes and gloves away from the moving parts.

Loose clothes, jewelry or long hair may get caught in moving parts.



If you have dust extraction and recollection devices connected onto the tool, inspect their connections and use them correctly.

Using these devices reduce dust-related risks.

Power tools use and care

Do not force the tool. Use the adequate tool for your application.

The correct tool delivers a better and safer job at the rate for which it was designed.



Do not use the tool if the switch is not working properly.

Any power tool that cannot be turned ON or OFF is dangerous and should be repaired before operating.

Disconnect the tool from the power source and / or battery before making any adjustments, changing accessories or storing.

These measures reduce the risk of accidentally starting the tool.

Store tools out of the reach of children. Do not allow persons that are not familiar with the tool or its instructions to operate the tool.

Power tools are dangerous in the hands of untrained users.



Service the tool. Check the mobile parts are not misaligned or stuck. There should not be broken parts or other conditions that may affect its operation. Repair any damage before using the tool.

Most accidents are caused due to poor maintenance to the tools.



Keep the cutting accessories sharp and clean.

Cutting accessories in good working conditions are less likely to bind and are easier to control.

Use the tool, components and accessories in accordance with these instructions and the projected way to use it for the type of tool when in adequate working conditions.

Using the tool for applications different from those it was designed for, could result in a hazardous situation.

Service

Repair the tool in a TRUPER Authorized Service Center using only identical spare parts.

This will ensure that the safety of the power tool is maintained.

Children or people with reduced physical, sensory or mental capabilities shall not operate the tool, neither inexperienced people or without knowledge in the use of the tool, unless supervised by a person responsible of their safety or if receiving previous instructions about the tool operation.

Children shall be kept under supervision to double-check they will not play with the tool. Tight supervision shall be used with children or disabled persons to prevent from using or being close to any household tool.



This tool is in compliance with the Official Mexican Standard (NOM - Norma Oficial Mexicana).

Safety warnings

for submersible pumps

TRUPER

Appropriate use of the pump

• This line of submersible pumps is designed to pump fresh and clean water from springs, wells and other water reservoirs, as well as water reservoirs or irrigation systems with clean water and solid particles up to 0.2"

CAUTION • To prevent blockages, do not operate the pump with waters containing larger particles.

WARNING • Do not pump corrosive, combustible or explosive substances (gasoline, petroleum, thinner nitrate) grease, oil, salt and sewer water.

CAUTION • The pump is not designed to operate continuously. Cannot be used replacing continuous use fixed pumps. The useful life of the pump will be shorter in relation to the use.

CAUTION • The pump is not adequate for commercial use, nor for permanent circulation and filtering systems, or to be used with liquids containing abrasive materials, or soil, sand, mud, or clay mixes. Any of those uses is considered inadequate and can damage the pump.

• The temperature of the liquids shall not exceed 95 °F, nor as cold as there is the possibility of freezing.

CAUTION • Prevent the pump from running dry.

WARNING • Do not use the pump in the nearness of areas where explosives, flammable liquids or gases are kept.

CAUTION • Any change or modification to the pump and the use of non-approved spare parts could damage the equipment and cause accidents.

WARNING • To prevent accidents, it is forbidden to wash things, swim or bathe into the water container where the pump is running.

CAUTION • Always verify the pump before each use, (especially the power cable and its plug). A damaged pump shall not be used. Go to a TRUPER Authorized Service Center to have it fixed.

CAUTION • Any type of repairs shall be carried out by a certified technician. If repairs are carried out in a faulty manner there is danger of liquid entering into the electric components.

WARNING • It is not advisable that people (including children), with reduced physical, sensorial or mental capacities, as well as people with no experience or knowledge, use the pump except if they are supervised by people responsible for their safety or having received previous instructions for the pump's use.

CAUTION • Children shall be supervised to ascertain they do not play with the pump. Strict supervision is required when people with reduced capacities or children use any power device or are close to them.

WARNING • Do not touch the power plug with wet hands. Always disconnect the plug and do not pull off the power cable. Do not use the power cable to lift, carry or hold the pump in any way. Do not use the cable for uses different to the specified use. Do not pull the cable while the pump is running. It can get damaged and cause an electric shock.

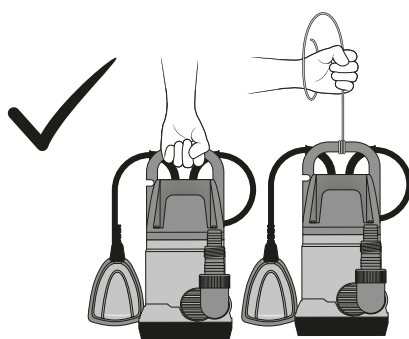
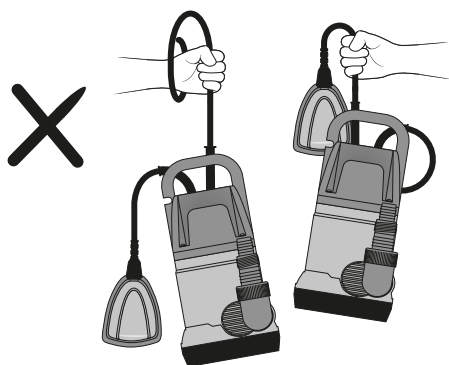

Safety warnings for submersible pumps



⚠ CAUTION • The connection source shall come from properly installed and tested grounded outlets. Power from the power supply and fuse shall match the pump's technical data.

⚠ CAUTION • The pump shall be connected through an RCCB (residual current breaker) with short circuit current design not lower to 30 mA

⚠ CAUTION • Before connecting double check the power supply matches the pump's requirements.

⚠ CAUTION • The pump shall be used only within the rated voltage, potency and rotation speed (see the manufacturer's nameplate).

⚠ WARNING • Do not entangle, tighten or run-over the power cable. Protect it from sharp edges, oil or heat.

⚠ CAUTION • Do not use extension cables with a lower gauge than the power cable gauge.

⚠ WARNING • In the event the power cable is damaged, disconnect the pump from the power supply immediately! Never run a pump if the power cable is damaged.

⚠ WARNING • Disconnect the plug from the power supply before removing the pump from the water or when servicing. 

⚠ CAUTION • Disconnect the pump when not in use.

⚠ CAUTION • Before connecting the pump to the power supply double check the float switch is set in the OFF position (A).

⚠ CAUTION • Before disconnecting the pump, the float switch shall be set in the OFF position (A).

⚠ WARNING • Do not install nor connect the pump if there are people or animals in the liquids to be pumped.

Parts

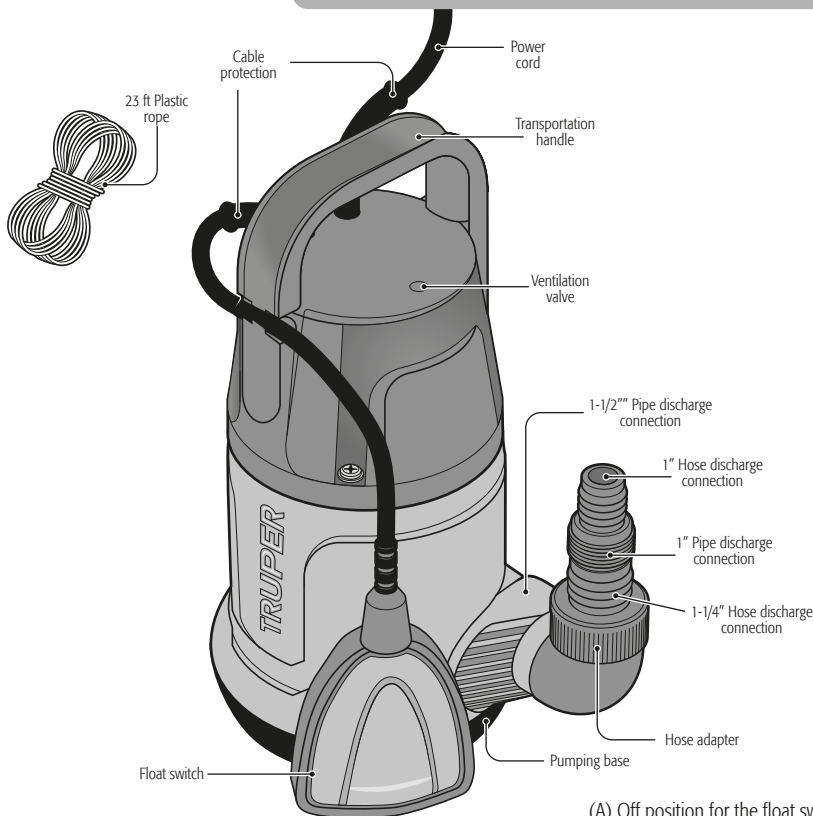

(A) Off position for the float switch

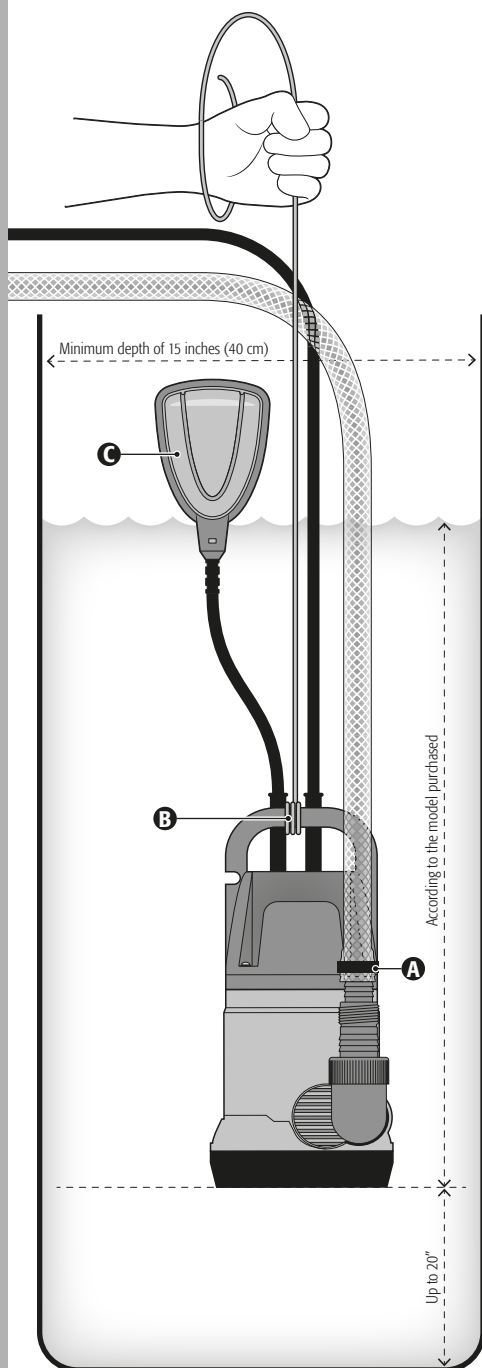

CAUTION • Before installing double check the pump, cable and plug are not showing any damage due to transportation and storage.

- Connect the hose into the discharge connection most suitable for the needs (A). Use a clamp to fasten the soft hoses and a soldered flange for steel hoses.
- To submerge the pump, tie one end of rope "included" onto the transportation handle (B).
- Hold the rope and immerse the pump.

CAUTION • Never use the power cable or the float switch to carry or hang the pump.

- Tie the other end of the rope to some fixed point to support the pump no deeper than the maximum depth marked for each model under the water surface and no less than 20" away from the bottom to prevent mud, particles, algae or residue blocking the pump.
- Double check there are no obstacles so that the float switch can move freely (C).

NOTE The minimum diameter where the pump is set shall be 15.7" so that the float switch can move freely.

Float switch

- The float switch goes On and OFF **automatically** depending on the water level height. When the float switch is placed into the same height as the transport handle, the pump starts; and when it goes down to approximately 4", it turns it off.
- To control the float switch **manually** and prevent the pump to automatically shut off, you may set the switch cable through the transport handle (D) so that the float cannot plunge down and shut off the pump.

⚠ CAUTION • When controlling the float switch manually keep on supervising the pump's functioning and prevent the water level to be so low it will make the pump operating dry.

⚠ CAUTION • The pump must be completely immersed in the liquid to function.

- ⚠ WARNING** • Avoid the pump operating dry, otherwise it can break down. When the water stops flowing, disconnect the pump immediately.
- The motor thermal protector shuts off the pump automatically in the event of overheating. Once the motor has cooled down, it will start again automatically.
 - After pumping chlorinated water from a swimming pool or another liquid with residues, you need to rinse the pump with clean water.
 - The submersible pump is equipped with a ventilation valve to prevent pressure leaks in the pump. Water entering through the valve can happen but is not a defect.

Float switch in
automatic
shut off position

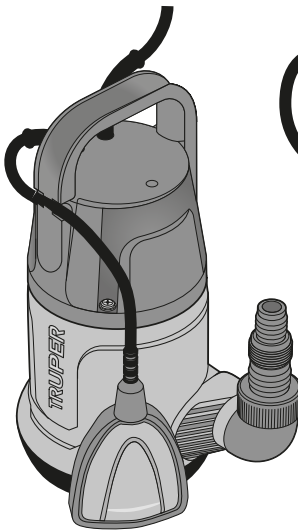

D
Float switch in
manual
shut off position

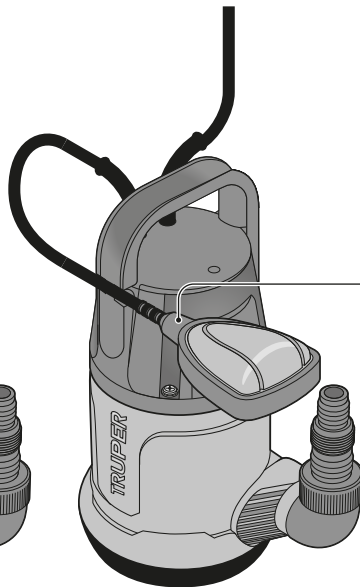

Maintenance

Cleaning and care

- Inspect regularly all the mounting screws and double check the screws are correctly tightened. In the event one of the screws is loose, tighten immediately.

Storage

- If frost is expected, store the pump in a dry place protected against frost. Otherwise the pump may be damaged.

Turbine cleaning

- In case there is contamination inside the pump, the suction base can be removed unscrewing the pan head screw fixing it to the pump's body. This way you can clean the turbine. For safety reasons a damaged turbine can only be replaced in a TRUPER Authorized Service Center.

Service

- Servicing tools can only be carried out in a TRUPER Authorized Service Center. Maintenance service carried out by people with no certification can turn dangerous and cause personal injury. Also, it makes the Warranty void.

Problem	Cause	Solution
The pump cannot be turned on or it suddenly stops while operating.	<ul style="list-style-type: none"> • No power. • The float is not changing its position. • The thermal switch shuts off the pump due to over-heating. • There are dirt particles into the suction base. 	<ul style="list-style-type: none"> • Check the cable, plug and fuse. • Set the pump correctly into the pool, well, etc. • Disconnect the plug and clean the turbine. Double check the water maximum temperature is 95 °F • Disconnect the plug and clean the suction base.
There is no flow.	<ul style="list-style-type: none"> • The suction base is clogged. • The pressure hose is bent. • Air is enclosed into the suction base. • The pump is set into shallow depth. 	<ul style="list-style-type: none"> • Disconnect the plug and clean the suction base. • Set the hose correctly. • Wait one minute at the most, until the pump degasifies automatically through the ventilation valve. If necessary, turn it off and start again. • Submerge the pump deeper.
The pump does not turn off.	<ul style="list-style-type: none"> • The float cannot sink in. 	<ul style="list-style-type: none"> • Set the pump adequately into the bottom of the pool, well, etc.
Insufficient flow.	<ul style="list-style-type: none"> • The suction base is clogged. • The pumping capacity can be reduced due to abrasive and dirty water. 	<ul style="list-style-type: none"> • Disconnect the plug and clean the suction base. • Take the pump to a TRUPER Authorized Service Center.
The pump shuts off after a short period working.	<ul style="list-style-type: none"> • The pump has thermal cut offs due to dirty water. • Water is too hot. Thermal cut offs shut down the pump. 	<ul style="list-style-type: none"> • Disconnect the main plug. Clean the pump and the axis. DO NOT try to pump dirty water. • Verify water temperature is not over 95 °F • Make sure the pump is fully submerged in the water.

If problems persist despite carrying out the corrective actions recommended, contact your TRUPER Authorized Service Center.

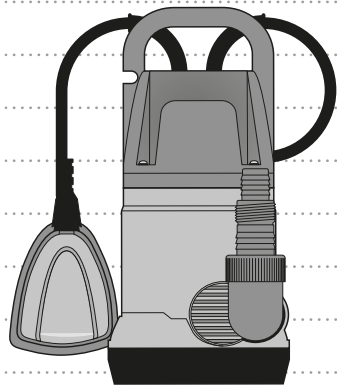

In the event of any problem contacting a Service Center, please see our webpage WWW.TRUPER.COM to get an updated list, or call our toll-free numbers 800 690-6990 or 800 018-7873 to get information about the nearest TRUPER Authorized Service Center.

AGUASCALIENTES **DE TODO PARA LA CONSTRUCCIÓN**
GRAL. BARRAGÁN #1201, COL. GREMIAL, C.P. 20030,
AGUASCALIENTES, AGS. TEL.: 449 994 0537

BAJA CALIFORNIA **SUCURSAL TIJUANA**
AV. LA ENCANTADA, LOTE #5, PARQUE INDUSTRIAL EL
FLORIDO II, C.P. 22244, TIJUANA, B.C.
TEL.: 664 969 5100

BAJA CALIFORNIA SUR **FIX FERRETERÍAS**
FELIPE ÁNGELES ESQ. RUIZ CORTÍNEZ S/N, COL. PUEBLO
NUEVO, C.P. 23670, CD. CONSTITUCIÓN, B.C.S.
TEL.: 613 132 1115

CAMPECHE **TORNILLERÍA Y FERRETERÍA AAA**
AV. ÁLVARO OBREGÓN #324, COL. ESPERANZA
C.P. 24080 CAMPECHE, CAMP. TEL.: 981 815 2808

CHIAPAS **FIX FERRETERÍAS**
AV. CENTRAL SUR #27, COL. CENTRO, C.P. 30700,
TAPACHULA, CHIS. TEL.: 962 118 4083

CHIHUAHUA **SUCURSAL CHIHUAHUA**
AV. SILVESTRE TERRAZAS #128-11, PARQUE INDUSTRIAL
BAFAR, CARRETERA MÉXICO CUAUHTÉMOC, C.P. 31415,
CHIHUAHUA, CHIH. TEL.: 614 434 0052

CIUDAD DE MEXICO **FIX FERRETERÍAS**
EL MONSTRUO DE CORREGIDORA, CORREGIDORA # 35,
COL. CENTRO, C.P. 06060, CUAUHTÉMOC, CDMX.
TEL.: 55 5522 5031 / 5522 4861

COAHUILA **SUCURSAL TORREÓN**
CALLE METAL MECÁNICA #280, PARQUE INDUSTRIAL
ORIENTE, C.P. 27278, TORREÓN, COAH.
TEL.: 871 209 68 23

COLIMA **BOMBAS Y MOTORES BYMTESA DE MANZANILLO**
BLVD. MIGUEL DE LA MADRID #190, COL. 16 DE
SEPTIEMBRE, C.P. 28239, MANZANILLO, COL.
TEL.: 314 332 1986 / 332 8013

DURANGO **TORNILLOS ÁGUILA, S.A. DE C.V.**
MAZURIO #200, COL. LUIS ECHEVERRÍA, DURANGO,
DGO. TEL.: 618 817 1946 / 618 818 2844

ESTADO DE MEXICO **SUCURSAL CENTRO JILOTEPEC**
PARQUE INDUSTRIAL # 1, COL. PARQUE INDUSTRIAL
JILOTEPEC, JILOTEPEC, EDO. DE MÉX. C.P. 54257
TEL.: 761 782 9101 EXT. 5728 Y 5102

GUANAJUATO **CÍA. FERRETERA NUEVO MUNDO S.A. DE C.V.**
AV. MÉXICO - JAPÓN #225, CD. INDUSTRIAL, C.P. 38010,
CELAJA, GTO. TEL.: 461 617 7578 / 79 / 80 / 88

GUERRERO **CENTRO DE SERVICIO ECLIPSE**
CALLE PRINCIPAL MZ.1 LT. 1, COL. SANTA FE, C.P. 39010,
CHILPANCIÑO, GRO. TEL.: 747 478 5793

HIDALGO **FERREPRECIOS S.A. DE C.V.**
LIBERTAD ORIENTE #304 LOCAL 30, INTERIOR DE PASAJE
ROBLODO, COL. CENTRO, C.P. 43600, TULANCINGO,
HGO. TEL.: 775 753 6615 / 775 753 6616

JALISCO **SUCURSAL GUADALAJARA**
AV. ADOLFO B. HORN # 6800, COL. SANTA CRUZ DEL
VALLE, C.P.: 45653, TLAJOMULCO DE ZÚÑIGA, JAL.
TEL.: 33 3606 5285 AL 90

MICHOACÁN **FIX FERRETERÍAS**
AV. PASEO DE LA REPÚBLICA #3140-A, COL.
EX-HACIENDA DE LA HUERTA, C.P. 58050, MORELIA,
MICH. TEL.: 443 334 6858

MORELOS **FIX FERRETERÍAS**
CAPITÁN ANZURES #95, ESQ. JOSÉ PERDIZ, COL.
CENTRO, C.P. 62740, CUAUTLA, MOR.
TEL.: 735 352 8931

NAVARRIT **HERRAMIENTAS DE TEPIC**
MAZATLAN #117, COL. CENTRO, C.P. 63000, TEPIC, NAY.
TEL.: 311 258 0540

NUEVO LEÓN **SUCURSAL MONTERREY**
CARRETERA LAREDO #300, 1B MONTERREY PARKS,
COLONIA PUERTA DE ANAHUAC, C.P. 66052, ESCOBEDO,
NUEVO LEÓN, TEL.: 81 8352 8791 / 81 8352 8790

OAXACA **FIX FERRETERÍAS**
AV. 20 DE NOVIEMBRE #910, COL. CENTRO, C.P. 68300,
TUXTEPEC, OAX. TEL.: 287 106 3092

PUEBLA **SUCURSAL PUEBLA**
AV. PERIFÉRICO #2-A, SAN LORENZO ALMECATLA,
C.P. 72710, CUAUTLACINGO, PUE.
TEL.: 222 282 8282 / 84 / 85 / 86

QUERÉTARO **ARU HERRAMIENTAS S.A. DE C.V.**
AV. PUERTO DE VERACRUZ #110, COL. RANCHO DE
ENMEDIO, C.P. 76842, SAN JUAN DEL RÍO, QRO.
TEL.: 427 268 4544

QUINTANA ROO **FIX FERRETERÍAS**
CARRETERA FEDERAL MZ. 46 LT. 3 LOCAL 2, COL. EJIDAL,
C.P. 77710 PLAYA DEL CARMEN, Q.R.
TEL.: 984 267 3140

SAN LUIS POTOSÍ **FIX FERRETERÍAS**
AV. UNIVERSIDAD #1850, COL. EL PASEO, C.P. 78320,
SAN LUIS POTOSÍ, S.L.P. TEL.: 444 822 4341

SINALOA **SUCURSAL CULIACÁN**
AV. JESÚS KUMATE SUR #4301, COL. HACIENDA DE LA
MORA, C.P. 80143, CULIACÁN, SIN.
TEL.: 667 173 9139 / 173 8400

SONORA **FIX FERRETERÍAS**
CALLE 5 DE FEBRERO #517, SUR LT. 25 MZ. 10, COL.
CENTRO, C.P. 85000, CD. OBREGÓN, SON.
TEL.: 644 413 2392

TABASCO **SUCURSAL VILLAHERMOSA**
CALLE HELIO LOTES 1, 2 Y 3 MZ. #1, COL. INDUSTRIAL,
2A ETAPA, C.P. 86010, VILLAHERMOSA, TAB.
TEL.: 993 353 7244

TAMAULIPAS **VM ORINGS Y REFACCIONES**
CALLE ROSITA #527 ENTRE 20 DE NOVIEMBRE Y GRAL.
RODRÍGUEZ, FRACC. REYNOSA, C.P. 88780, REYNOSA,
TAMS. TEL.: 899 926 7552

TLAXCALA **SERVICIOS Y HERRAMIENTAS INDUSTRIALES**
PABLO SIDAR #132, COL. BARRIO DE SAN BARTOLOMÉ,
C.P. 90970, SAN PABLO DEL MONTE, TLAX.
TEL.: 222 271 7502

VERACRUZ **LA CASA DISTRIBUIDORA TRUPER**
BLVD. PRIMAVERA ESQ. HORTENSIA S/N, COL.
PRIMAVERA, C.P. 93508, POZA RICA, VER.
TEL.: 782 823 8100 / 826 8484

YUCATÁN **SUCURSAL MÉRIDA**
CALLE 33 #600 Y 602, LOCALIDAD ITZINCAB Y Mulsay,
MPIO. UMAN, C.P. 97390, MÉRIDA, YUC.
TEL.: 999 912 2451

Code	Models	Brand
12601	BOS-1/2LP	TRUPER
12600	BOS-3/4LP	
12602	BOS-1LP	

Warranty. Duration: 1 year. Coverage: parts, components and workmanship against manufacturing or operating defects, except if used under conditions other than normal; when it was not operated in accordance with the instructive; was altered or repaired by personnel not authorized by TRUPER®. To make the warranty valid, present the product, stamped policy or invoice or receipt or voucher, in the establishment where you bought it or in Corregidora 35, Centro, Cuauhtémoc, CDMX, 06060, where you can also purchase parts, components, consumables and accessories. It includes the costs of transportation of the product that derive from its fulfillment of its service network. Phone number 800-018-7873. Made in China. Imported by TRUPER, S.A. de C.V. Parque Industrial 1, Parque Industrial Jilotepec, Jilotepec, Edo. de Méx. C.P. 54257, Phone number 761 782 9100.



Stamp of the business. Delivery date: